



High Pressure Ball Valve(With SAE Joint)

High Pressure Ball Valve(With SAE Joint)

一、 BKH-SAE-FS MKH-SAE-FS

1 Model Code

BKH-SAE-FS - **210** - **13** - **1** **1** **2** **3** - ※
 (1) (2) (3) (4) (5) (6) (7) (8)

- 1.Series Code: BKH-SAE-FS-Squared type
MKH-SAE-FS-Casting Round type
 - 2.Nominal Pressure:210、 420bar
 - 3.Nominal Size:13、 20...mm
 - 4.Valve Body Material: 1-carbon steel, 2-stainless steel
 - 5.Ball Body Material: 1-alloy steel, 3-stainless steel
 - 6.Ball Sealing Material:1-POM
 - 7.Other Sealing Material:2-NBR,4-FPM/FKM
 - 8.Surface Treatment:Blank-phosphorization
- Please inform us of the detail if you want other treatment



2 Overall Size

(1).BKH-SEA-FS

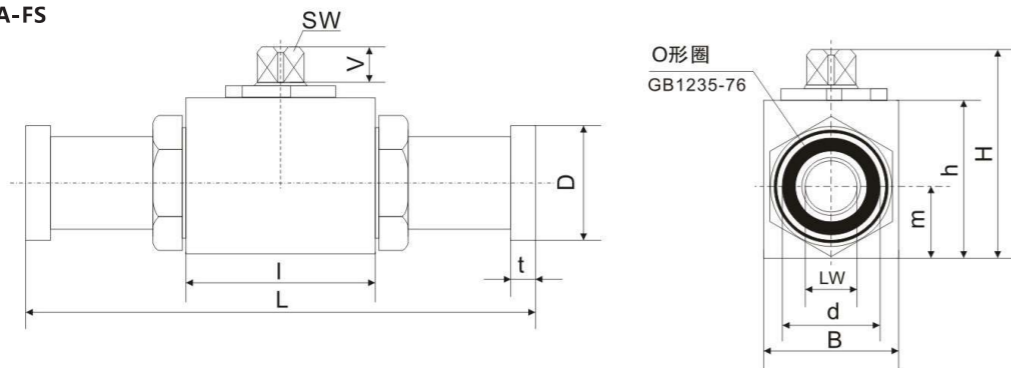

210bar(3000psi)															
Model	DN ⁽¹⁾	PN ⁽²⁾	LW	L	I	B	H	h	m	V	SW	d	D	t	Weight kg
BKH-SAE-FS-210	13	210	13	151	48	35	52.5	40	17	8	9	25	30.2	6.8	0.8
BKH-SAE-FS-210	20	210	19	162	60	48	75	57	24	12	14	32	38.1	6.8	1.9
BKH-SAE-FS-210	25	210	25	178	64	57	82	64	28.5	12	14	40	44.4	8.1	2.75

420bar(6000psi)															
Model	DN ⁽¹⁾	PN ⁽²⁾	LW	L	I	B	H	h	m	V	SW	d	D	t	Weight kg
BKH-SAE-FS-420	13	420	13	151	48	35	52.5	40	19	8	9	25	31.8	7.9	0.9
BKH-SAE-FS-420	20	315	19	174	60	48	75	57	24	12	14	32	41.8	8.9	1.95
BKH-SAE-FS-420	25	315	25	198	64	57	82	64	28.5	12	14	40	47.6	9.6	3

注: (1) DN in mm; (2) PN in bar

High Pressure Ball Valve (With SAE Joint)

(2).MKH-SEA-FS

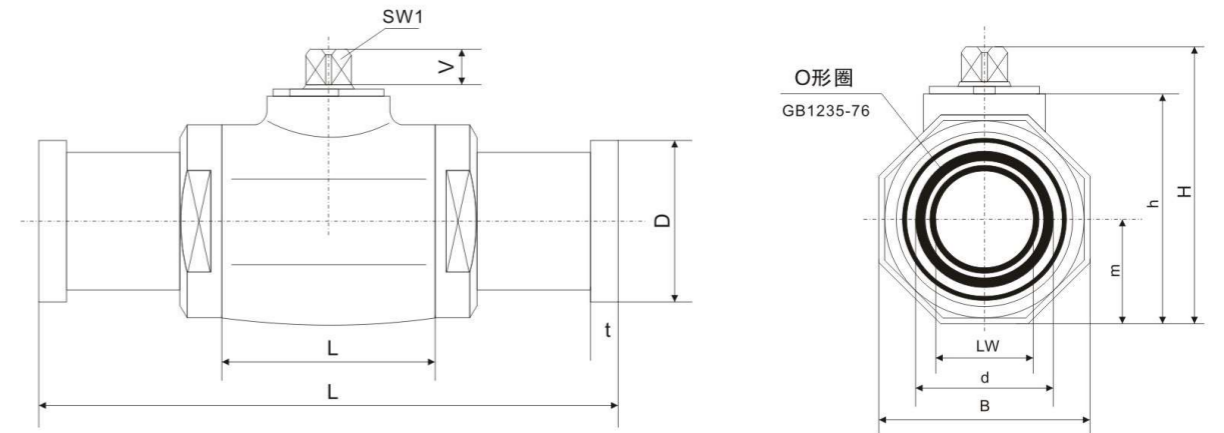

210bar(3000psi)															
Model	DN ⁽¹⁾	PN ⁽²⁾	LW	L	I	B	H	h	m	V	SW	d	D	t	重量 kg
MKH-SAE-FS-210	32	210	30	191	84	75	104.5	84	37.5	14	17	45	50.8	8.1	4
MKH-SAE-FS-210	40	210	38	231	91	85	115.5	95	42.5	14	17	55	60.3	8.1	6.2
MKH-SAE-FS-210	50	210	48	232	100	105	133	112.5	52.5	14	17	65	71.4	9.6	9.1

420bar(6000psi)															
Model	DN ⁽¹⁾	PN ⁽²⁾	LW	L	I	B	H	H ^{+0.5}	m	V	SW	d	D	t	重量 kg
MKH-SAE-FS-420	32	350	30	223	84	75	104.5	84	37.5	14	17	45	54	10.4	4.5
MKH-SAE-FS-420	40	350	38	281	91	85	115.5	95	42.5	14	17	55	63.5	12.7	7.2
MKH-SAE-FS-420	50	350	48	316	100	105	133	112.5	52.5	14	17	65	79.4	12.7	10.8

注: (1) DN in mm; (2) PN in bar